		DIN11851 Male, Imperial OD Tube				
		Inch Size	Dimensions [mm]			
		OD	WT	THD OD	L1	
1.00"		25.65	1.7	RD52X1/6"	29.0	D51.M.100
1.50"		38.35	1.7	RD65X1/6"	33.0	D51.M.150
2.00"		51.05	1.7	RD78X1/6"	35.0	D51.M.200
2.50"		63.75	1.7	RD95X1/6"	40.0	D51.M.250
3.00"		76.45	1.7	RD110X1/4"	45.0	D51.M.300
4.00"		101.85	2.1	RD130X1/4"	54.0	D51.M.400

		DIN11851 Liner, Imperial OD Tube				
		Inch Size	Dimensions [mm]			
		OD	WT	C	L1	
1.00"		25.65	1.7	44.0	22.0	D51.L.100
1.50"		38.35	1.7	56.0	26.0	D51.L.150
2.00"		51.05	1.7	68.0	28.0	D51.L.200
2.50"		63.75	1.7	86.0	32.0	D51.L.250
3.00"		76.45	1.7	100.0	37.0	D51.L.300
4.00"		101.85	2.1	121.0	44.0	D51.L.400

		DIN11851 Round Slotted Nut, Imperial OD Tube				
		Inch Size	Dimensions [mm]			
		A	B	THD OD	L1	
1.00"		63.0	36.0	RD52X1/6"	21.0	D51.N.100
1.50"		78.0	49.0	RD65X1/6"	21.0	D51.N.150
2.00"		92.0	62.0	RD78X1/6"	22.0	D51.N.200
2.50"		112.0	80.0	RD95X1/6"	25.0	D51.N.250
3.00"		127.0	94.0	RD110X1/4"	29.0	D51.N.300
4.00"		138.0	115.0	RD130X1/4"	31.0	D51.N.400

		DIN11851 Standard Seal, Imperial OD Tube				
		Inch Size	Dimensions [mm]			
		A	B	W		
1.00"		40.0	30.0	5.0		D51.S.100
1.50"		52.0	42.0	5.0		D51.S.150
2.00"		64.0	54.0	5.0		D51.S.200
2.50"		81.0	71.0	5.0		D51.S.250
3.00"		95.0	85.0	5.0		D51.S.300
4.00"		114.0	104.0	6.0		D51.S.400

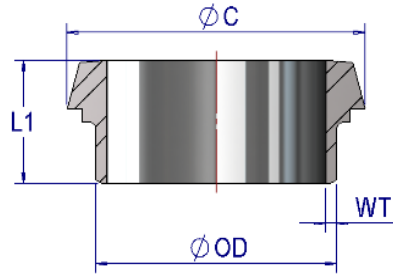
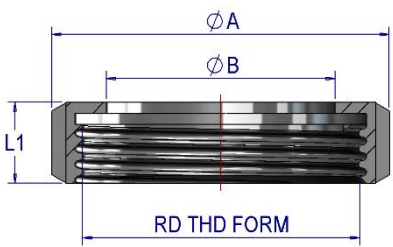
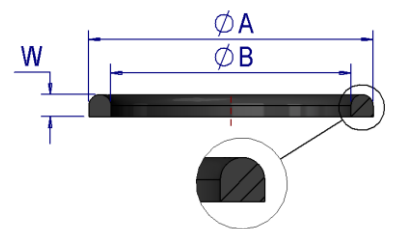

DIN11851 Inner Lip Hygienic Seal, Imperial OD Tube					
Inch Size	Dimensions [mm]			Part Code	
	A	B	W		
1.00"	40.0	22.2	5.0	D51.SL.100	
1.50"	52.0	34.9	5.0	D51.SL.150	
2.00"	64.0	47.6	5.0	D51.SL.200	
2.50"	81.0	60.3	5.0	D51.SL.250	
3.00"	95.0	73.0	5.0	D51.SL.300	
4.00"	114.0	97.6	6.0	D51.SL.400	

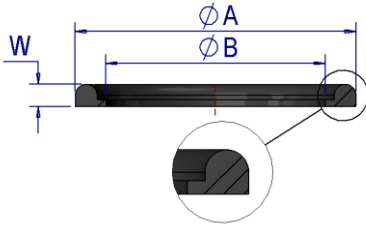

Material Grade	Part	Add Code	Product Specification	
316L / 1.4404 Stainless Steel	DN11851 Male	.6	Certification Available	EN10204 3.1
316L / 1.4404 Stainless Steel	DIN11851 Liner	.6	Suits Tube Standard	BS4825-1
304L / 1.4307 Stainless Steel	DIN11851 Nut	.6		