

Tri-Clamp Fittings

TC Clamps, GRQX

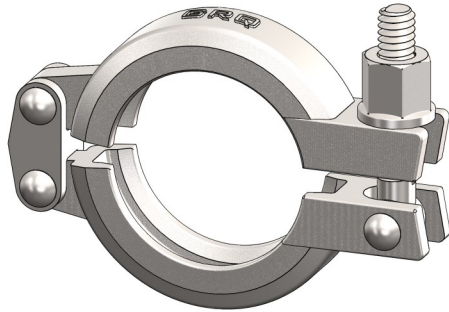

Engineered Hex Nut, Replaces Standard Wing-Nut

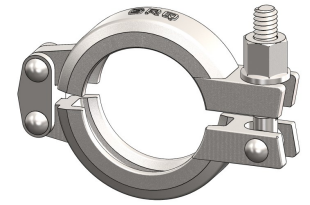
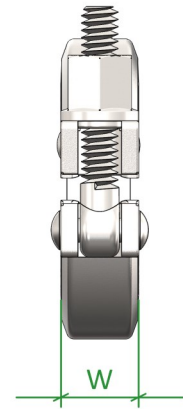
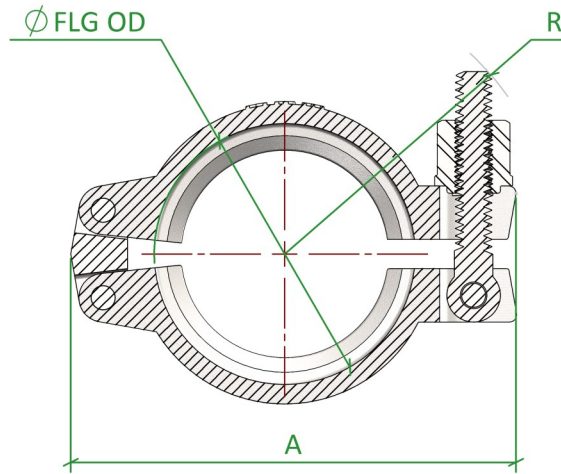

Standard	Universal / Suits ALL TC Fittings Standards	Certification	TUV Pressure Test Report Upon Request
Connections	TC Fitting , 13MHHMD	Associated Parts	TC Ferrules TC Gasket, TC Blanks
Material	304 Cast Stainless Steel EN 1.4401	Associated Standards	ALL International TC Ferrule Standards
Surface Finish	Barrel Polished, Approx. 1.2Ra	Options	Available with a Wing-Nut replacing Hex Nut
Remarks	Patented Clamp, Designed Specifically To Be Universal With All International Tri-Clamp Standard.		

TC Fittings, TC Clamp, Universal / All Standards, GRQX (With Hex Nut)

Size (inch)	FLG OD (mm)	A (mm)	W (mm)	R (mm)	Pressure Rating @ 90°C (bar)	Pressure Rating @ 90°C (psi)	Part Code
0.500"-0.075"	25.40	62	16	48	50	725	CC.GRQX.0050-0075.4
DN10/15/20	34.00	73	16	52	50	725	CC.GRQX.D010-D020.4
1.000"-1.500"	50.50	93	16	57	50	725	CC.GRQX.0100-0150.4
2.000"	64.00	107	16	62	50	725	CC.GRQX.0200.4
2.500"	77.50	120	16	68	50	725	CC.GRQX.0250.4
3.000"	91.00	134	16	73	40	580	CC.GRQX.0300.4
3.500"	106.00	149	16	80	30	435	CC.GRQX.0350.4
4.000"	119.00	162	16	86	25	363	CC.GRQX.0400.4
4.500"	130.00	173	16	91	25	363	CC.GRQX.0450.4
5.000"	144.40	192	17	101	25	363	CC.GRQX.0500.4
5.500"	155.00	205	23	107	25	363	CC.GRQX.0550.4
6.000"	167.00	219	23	113	20	290	CC.GRQX.0600.4
6.580"	183.00	233	23	120	20	290	CC.GRQX.0658.4
8.000"	217.40	268	23	137	15	218	CC.GRQX.0800.4
8.580"	233.50	292	23	144	15	218	CC.GRQX.0858.4
10.000"	268.00	319	24	162	12	174	CC.GRQX.1000.4
10.750"	286.10	338	24	171	12	174	CC.GRQX.1075.4
12.000"	319.00	371	24	188	10	145	CC.GRQX.1200.4
12.750"	338.00	391	24	198	9	131	CC.GRQX.1275.4

Published Data Is Given in Good Faith. We Reserve the Right To, Without Warning Change the Dimensions When Not In Conflict With The Published Standard

Flowsource Process Fittings Ltd

Unit 4 Marrtree Business Park, Cedar Road, Sowerby, Thirsk, North Yorkshire, YO7 3FF, United Kingdom
 [T] 01535 274 316 - [e] sales@flowsourcepf.com - [w] www.flowsourcepf.com

FLWSOURCE
PROCESS FITTINGS